

DF 4065

Manual Copy Routing Machine

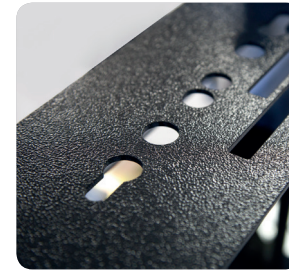

- Manual control with the guideness of tracking tip.
- Copy routing with 1:1 ratio template.

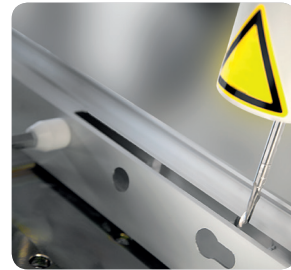
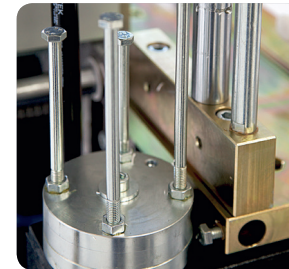

- Practical height adjustment with rotating support stoppers.

General Features

- Opens the espagnolette canal, lock and barrel slot holes on the aluminum profiles.
- The copy routing motor is easily operated with one button.
- Thanks to the support mills, the canals are opened without template.

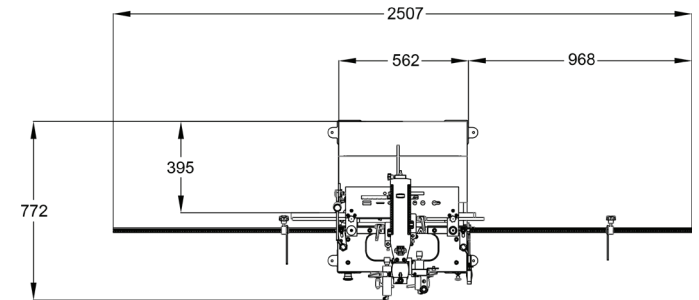

Optional Equipments



- MR 100 Centering Device

<p>H: 1700 mm W: 850-2507 mm L: 750 mm</p>	<p>230 V L1-N-PE 50 / 60 Hz 1,4 KW</p>	<p>115 kg</p>	<p>6-8 Bar 340 l / min</p>	<p>A: 105 mm B: 95 mm C: 260 mm</p>	<p>∅D: 5,2 mm ∅D1: 8 mm ∅D2: 8 mm 18.000 rpm</p>	<p>a [max: 120 mm h [min: 5 mm max: 100 mm</p>
--	--	---------------	--------------------------------	---	--	--